

ELKHART COACH PROUDLY PRESENTS

# EC-II



**OVERLAND**  
CUSTOM COACH (2007) INC.

[www.overlandcustomcoach.com](http://www.overlandcustomcoach.com)

# EC-II STANDARDS & OPTIONS

## STANDARD CHASSIS FEATURES

- Ford E-450 DRW Cut-Away Chassis
- Electronic 5-Speed Automatic Transmission
- 55-Gallon Fuel Tank
- Ford V-8 6.8L Gas EFI Engine
- OEM Installed Dash Air Conditioning and Heat
- 130 Amp Alternator
- 158", 176", or 186" Wheelbase
- Heavy Duty Engine Cooling Package
- Chrome Front Bumper and Grill
- 14,500 GVWR
- Dual Electric Horns
- Driver Air Bag
- Heavy Duty Suspension
- Power Steering/Brakes
- LT225/75RX16E Tires
- Dual 650 CCA Batteries
- Tilt Steering Wheel/Cruise Control
- Dual Beam Headlights

- Entrance Door and Driver Modesty Panels
- All Aluminum Sidewalls and Skirts
- Dual Drive Shaft Guards
- Entry Door Assist Hand Rails
- Fully Welded Unitized Steel Cage Body Structure
- Undercoating
- Swing-A-Way Exterior Flat Mirrors with Integrated Convex Panels
- Drip Rail Over Passenger Windows and Entry Doors
- White Step Nosing – All Entry Steps
- Color/Function Coded Wiring Harness
- Laminated Steel Reinforced Composite Construction
- Master Electronic Printed Circuit Control Panel
- Side and Rear Emergency Egress Windows
- Stylized ABS Rear Trim
- 91" Interior Width and 77" Headroom
- Large 36" x 36" Upper T-Slider Windows
- Single Piece Seamless FRP Roof
- Smooth FRP Interior Walls
- FRP Ceiling

- Spare Tire and Wheel
- Interior Luggage Rack
- Interior Convex Mirror
- Back-Up Alarm
- Overhead Luggage Racks
- Exterior Rear Center Mounted Brake Light
- Upgraded Dual Alternators (Diesel Only)
- Rear Luggage Compartment
- Ceiling Grab Rails
- AM/FM Radio with CD Player
- "Flat Floor" (No Wheel Well Risers)
- DVD Player with Flip Down Monitor
- Heated/Remote Exterior Mirrors
- High-Back or Mid-High Seats with Armrests
- Front Mud Flaps
- Ground Plane For Two-Way Radio Installation
- Paging System
- Rear Emergency Door with Ajar Package
- LED Exterior Lighting
- Rear A/C System
- Roof Escape Hatch
- Stainless Steel Wheel Inserts
- ADA Mobility Compliance Package
- All FRP Exterior
- Driver Running Board
- Electric Entry Door

## STANDARD BODY FEATURES

- FMVSS Certified
- STURAA Tested for 7 Years/200,000 Miles
- Insulated Roof and Exterior Walls
- Mor-View Right Side Cab Window
- Smooth Rubber Floor with Ribbed-Rubber Aisles
- Rear ABS Fender Flares
- Powder Coated Rear Steel Bumper
- Rear Mud Flaps

## POPULAR OPTIONS

- Ford V-8 6.0L Diesel EFI Engine
- Rear Heat System
- Front and Side Destination Signs
- Mor/Ryde Suspension
- Individual Reading Lights

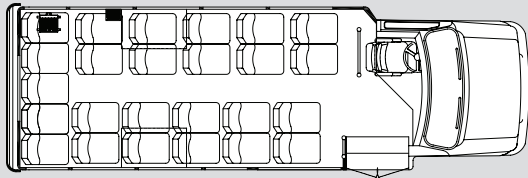

25 Passenger - Forward Facing Seating

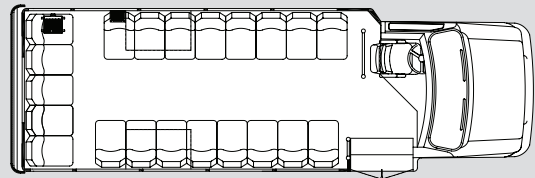

21 Passenger Perimeter Seating

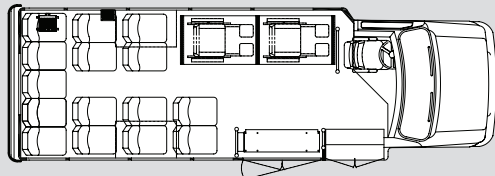

15 Passenger - 2 Wheelchairs - Front Lift

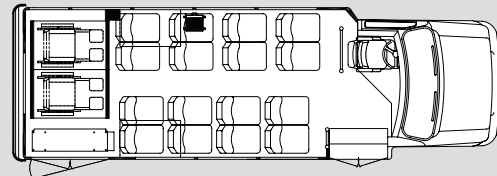

16 Passenger - 2 Wheelchairs - Rear Lift



CUSTOM COACH (2007) INC.

R.R.#2, 21051 Nissouri Rd  
Thorndale, ON N0M 2P0

P: 519-461-1140  
F: 519-461-0523

Shuttle - Transit - ParaTransit - Specialty - Limobus

[www.overlandcustomcoach.com](http://www.overlandcustomcoach.com)